

11. ALTERNATOR

COMPONENT LOCATION	11-2	STATOR	11-6
SERVICE INFORMATION	11-3	FLYWHEEL	11-7
ALTERNATOR COVER.....	11-4		

ALTERNATOR

COMPONENT LOCATION

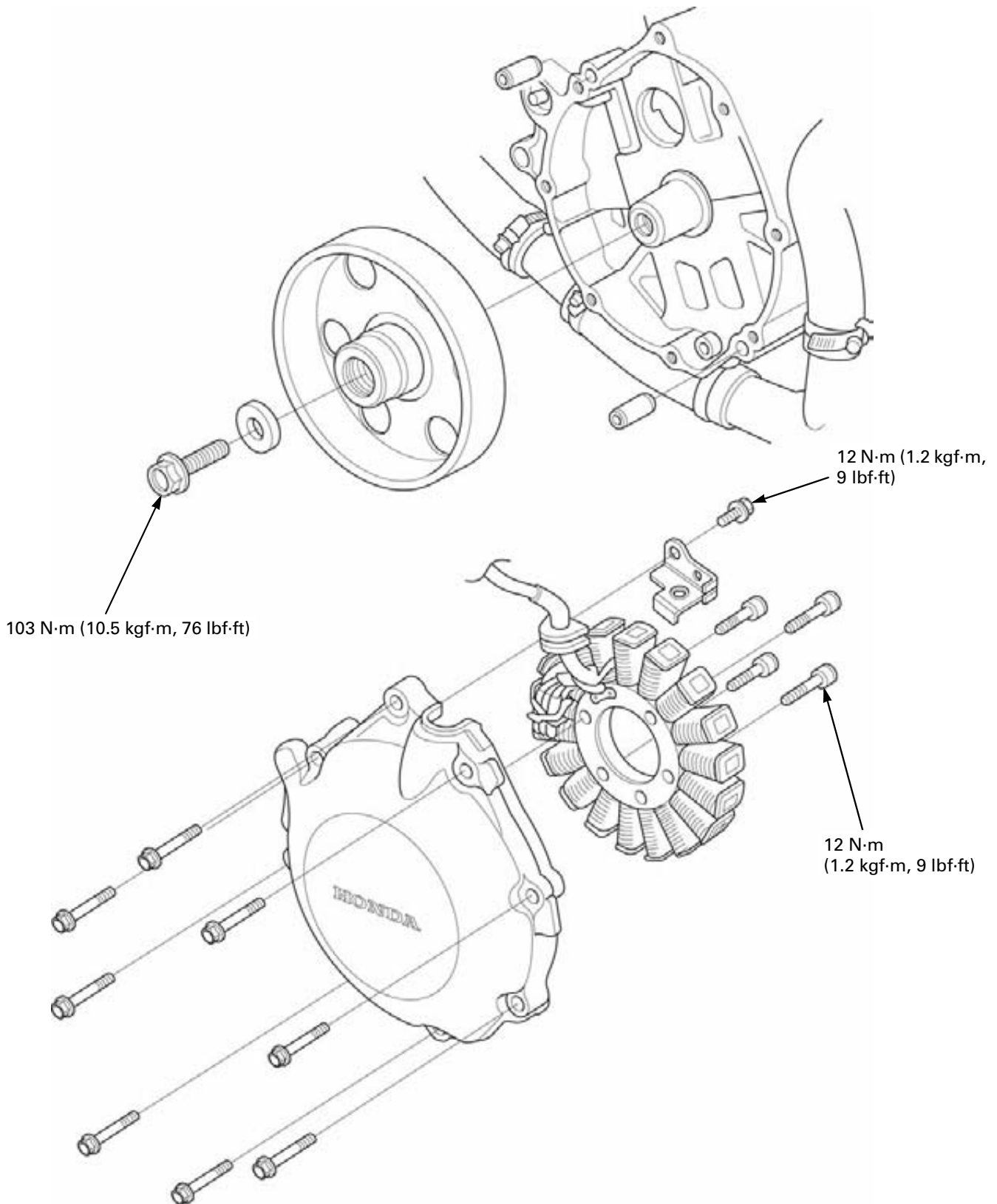

SERVICE INFORMATION

GENERAL

- This section covers service of the alternator stator and flywheel. All service can be done with the engine installed in the frame.
- Refer to procedures for alternator stator inspection (page 18-8).
- Refer to procedures for starter motor servicing (page 20-6).

TORQUE VALUES

Stator wire clamp bolt	12 N·m (1.2 kgf·m, 9 lbf·ft)	CT bolt Apply oil to the threads and seating surface.
Flywheel flange bolt	103 N·m (10.5 kgf·m, 76 lbf·ft)	
Stator mounting socket bolt	12 N·m (1.2 kgf·m, 9 lbf·ft)	

TOOLS

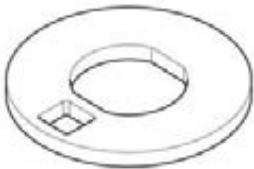
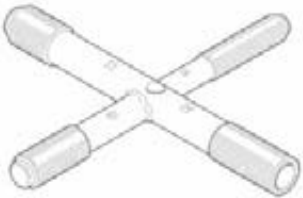
<p>Flywheel holder 070MB-MELC100</p> 	<p>Rotor puller 07733-0020001</p> 
--	--

ALTERNATOR

ALTERNATOR COVER

REMOVAL

Remove the left rear cowl (page 3-8).

Remove the wire band and disconnect the alternator 3P (White) connector.

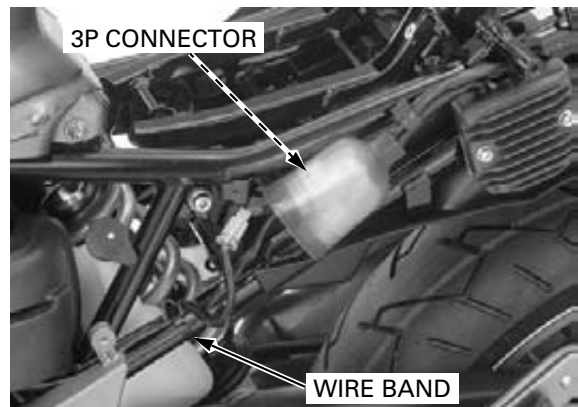

Unhook the alternator wire from the clamp.

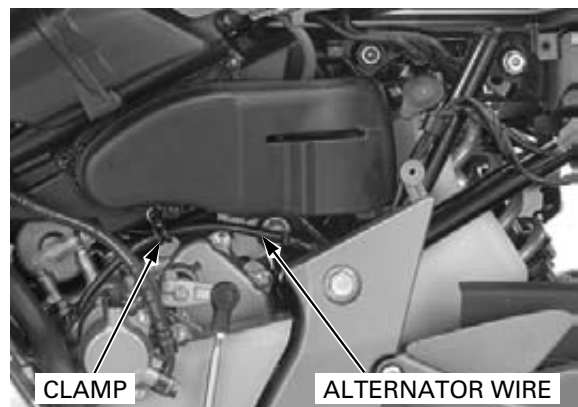

The alternator cover (stator) is magnetically attached to the flywheel, be careful during removal.

Remove the alternator cover bolts and alternator cover.

- Engine oil will run out when the alternator cover is removed. Set a clean oil pan under the engine and add the recommended oil to the specified level after installation.

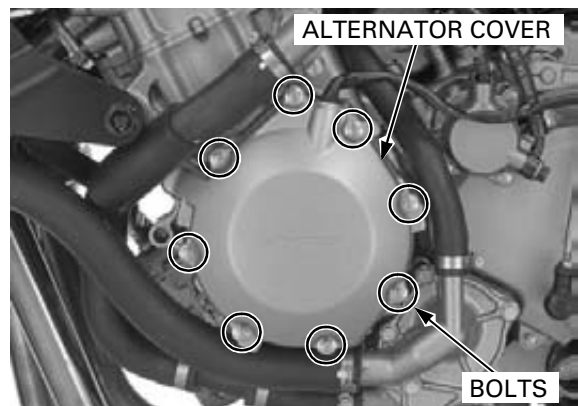

Remove the dowel pins.

Clean off any sealant from the crankcase mating surfaces.

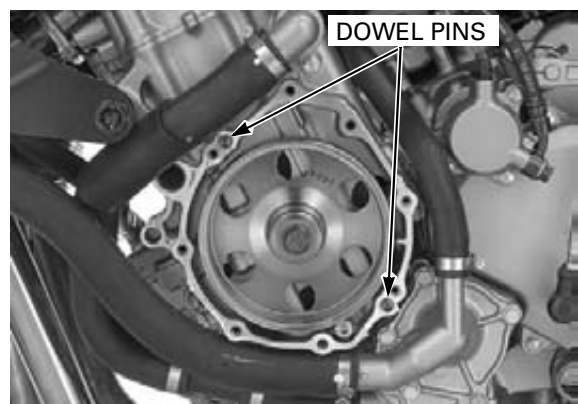

INSTALLATION

Apply a sealant (Three Bond 1207B) to the mating surface of the alternator cover.

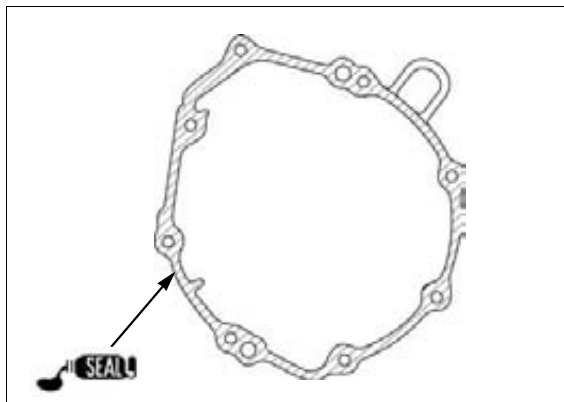

Install the dowel pins.

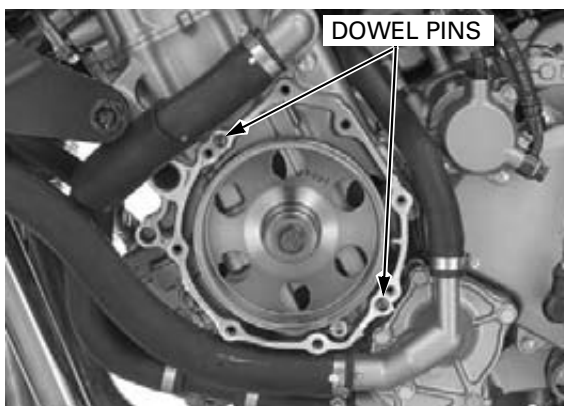

The alternator cover (stator) is magnetically attached to the flywheel, be careful during installation.

Install the alternator cover.
Install and tighten the bolts securely.

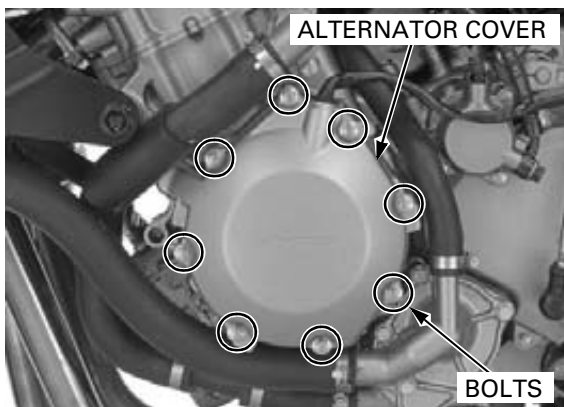

Connect the alternator 3P (White) connector.
Secure the alternator wire with the wire band.

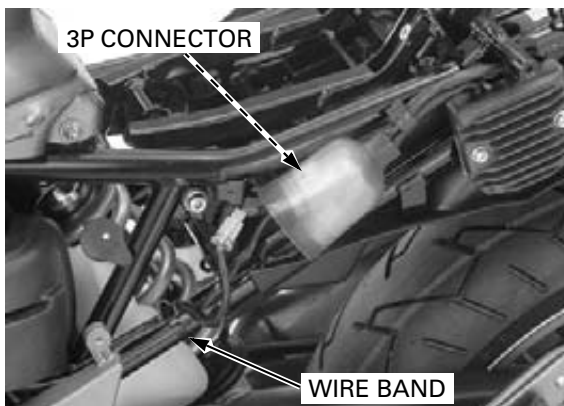

ALTERNATOR

Hook the alternator wire on the clamp.
Install the left rear cowl (page 3-8).

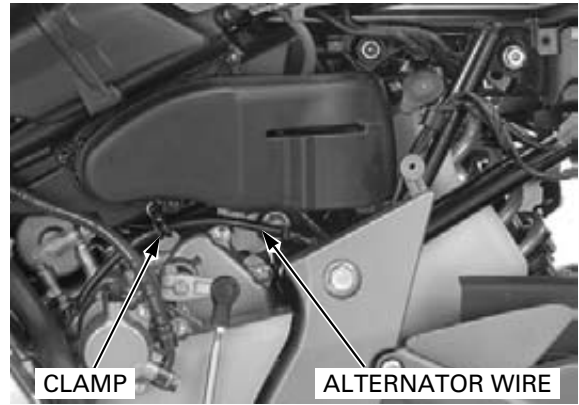

STATOR

REMOVAL

Remove the alternator cover (page 11-4).
Remove the bolt and stator wire clamp.
Remove the alternator wire grommet from the alternator cover.
Remove the socket bolts and stator.

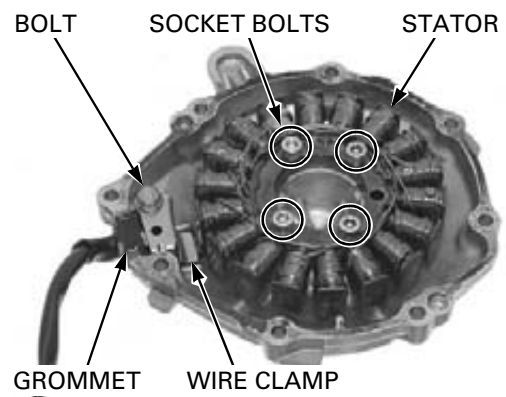

INSTALLATION

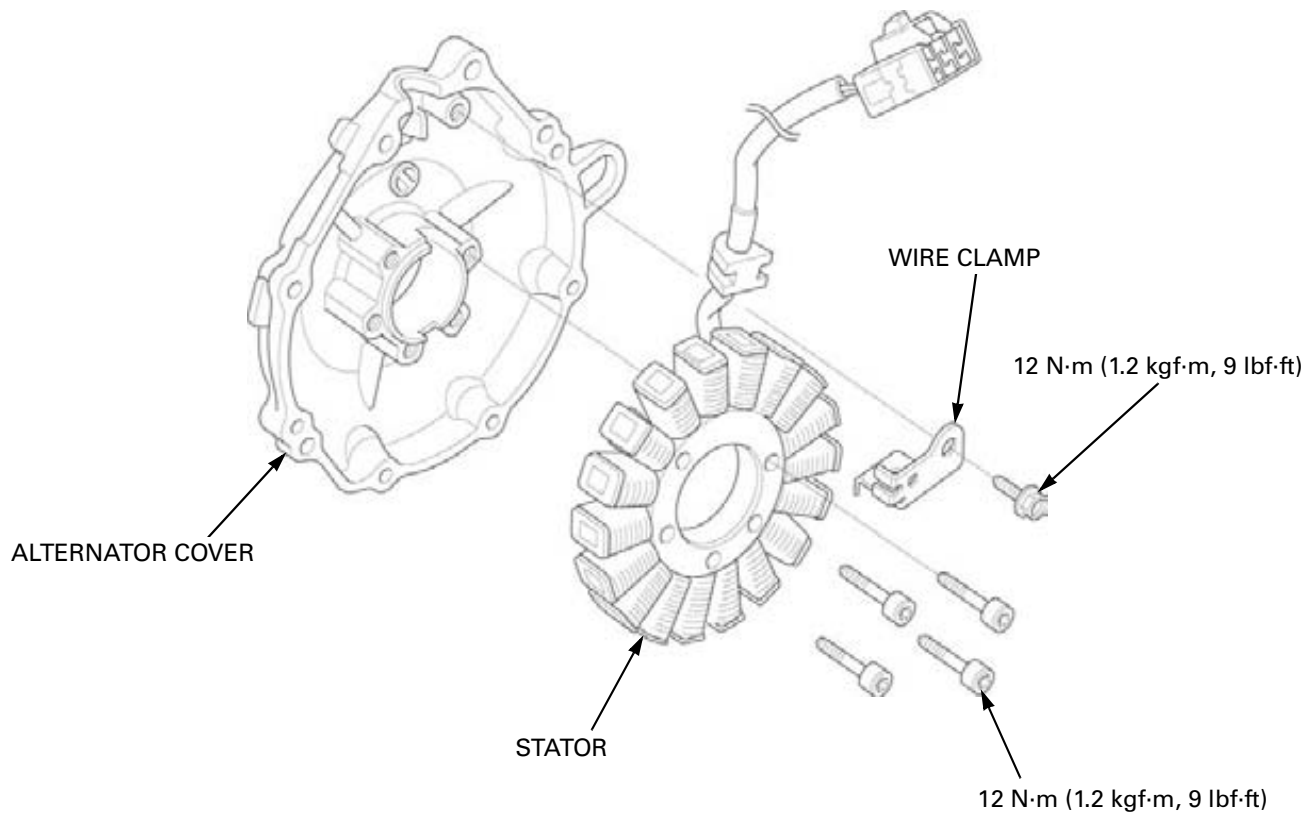

Install the stator into the alternator cover.

Apply sealant to the wire grommet, then install the wire grommet into the alternator cover groove securely.
Install and tighten the socket bolts to the specified torque.

TORQUE: 12 N·m (1.2 kgf·m, 9 lbf·ft)

Install the wire clamp and tighten the flange bolt to the specified torque.

TORQUE: 12 N·m (1.2 kgf·m, 9 lbf·ft)

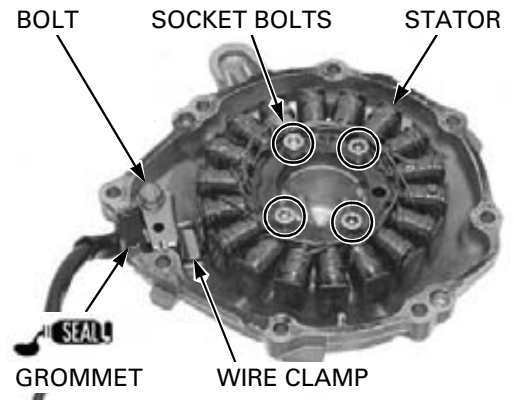

FLYWHEEL

REMOVAL

Remove the alternator cover (page 11-4).

Hold the flywheel using the special tool, then loosen the flywheel bolt.

TOOL:

Flywheel holder **070MB-MELC100**

Remove the washer and flywheel bolt.

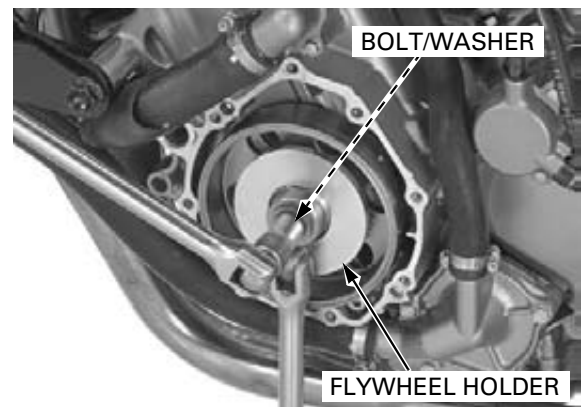

Remove the flywheel using the special tool.

TOOL:

Rotor puller **07733-0020001**

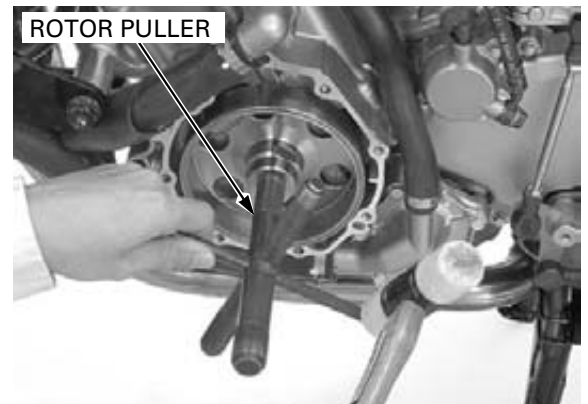

INSTALLATION

Clean any oil from the crankshaft taper area.

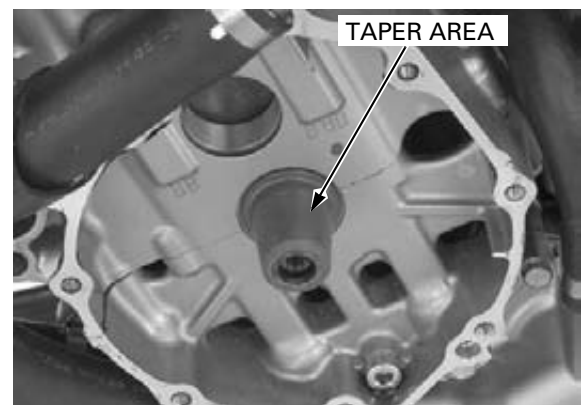

ALTERNATOR

Install the flywheel.

Apply oil to the flywheel bolt threads and seating surface.

Install the washer and flywheel bolt.

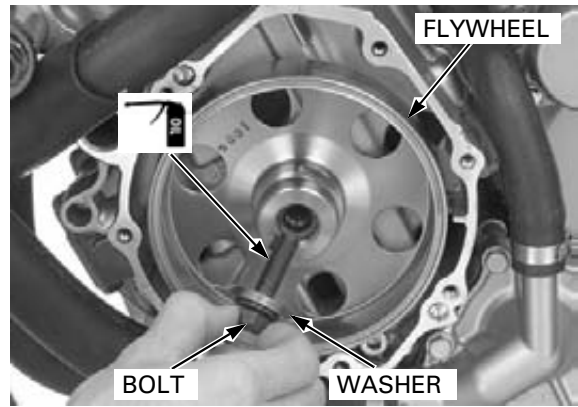

Hold the flywheel using the special tool, then tighten the bolt to the specified torque.

TOOL:

Flywheel holder **070MB-MELC100**

TORQUE: 103 N·m (10.5 kgf·m, 76 lbf·ft)

Install the alternator cover (page 11-5).

