

2. Frame/Body Panels/Exhaust System

Service Information	2-1	Fairing Pocket	2-6
Seat	2-2	Windshield	2-6
Side Cover	2-2	Instrument Panel	2-7
Saddlebag	2-2	Middle Fairing Inner Cover	2-7
Seat cowling	2-3	Middle Fairing	2-8
Saddle Bag Stay	2-3	Rearview Mirror	2-8
Rear Fender	2-4	Upper Fairing	2-9
Lower fairing	2-4	Front Fender (LBS-ABS/TCS model)	2-11
Pivot Cover	2-5	Fuel Tank	2-12
Maintenance Cover	2-5	Muffler	2-13
Top Shelter	2-5	Exhaust Pipe	2-18

Service Information

⚠ WARNING

- Gasoline is extremely flammable and explosive under certain conditions.
- Serious burns may result if the exhaust system is not allowed to cool before components are removed or serviced.

- Work in a well ventilated area. Smoking or allowing flames or sparks in the work area or where gasoline is stored can cause a fire or explosion.
- This section covers removal and installation of the frame body panels, fuel tank and exhaust system.
- Frame body panel installation is in the reverse order of removal, unless noted otherwise.
- When removing the covers be careful not to damage any tabs or grooves on the covers.

Seat

Unlock the seat with the ignition key.
Push the front of the seat and remove the seat by pulling it rearward.

Install the seat by aligning the four tabs and one hole as shown, and lock it by pushing it down securely.

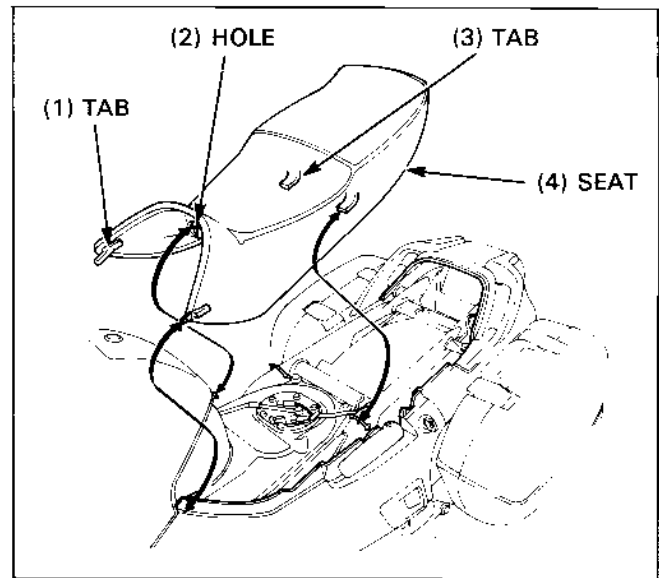

Side Cover

Remove the seat.

Remove the attaching screw and trim clip, and release the three bosses from the grommets, being careful not to damage the tab. Remove the side cover.

NOTE

- On the left side cover, pull the center stand grip outward when removing the cover.

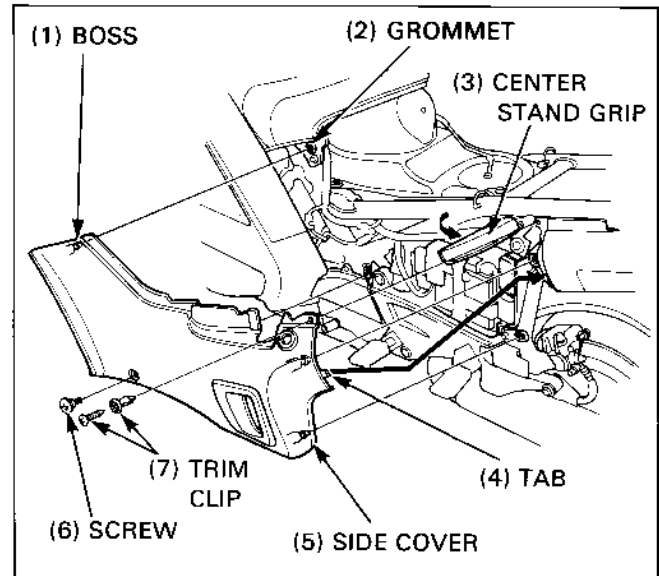

Saddlebag

Unlock the saddlebag lock lever with the ignition key.
Release the saddlebag hook by pulling the lock lever.
Slide the saddle bag rearward and raise it slightly to remove it.

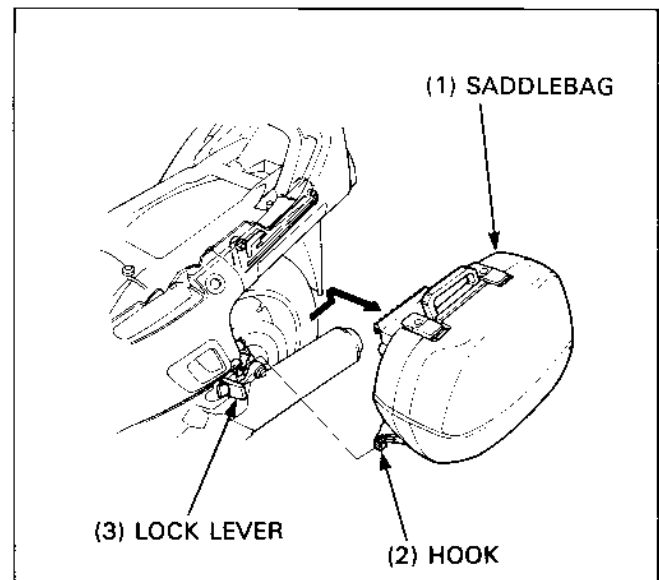

Seat Cowling

Remove the left and right side covers and saddle bags.

Remove the four socket head caps.

Remove the four socket bolts, two 8 mm bolts and the left and right grab rails.

Remove the two 6 mm bolts, ground terminal (After '95) and collars, disconnect the tail/brake light connector, and remove the seat cowling.

Torque:

Grab rail bolts: 27 N·m (2.7 kg-m, 20 ft-lb)

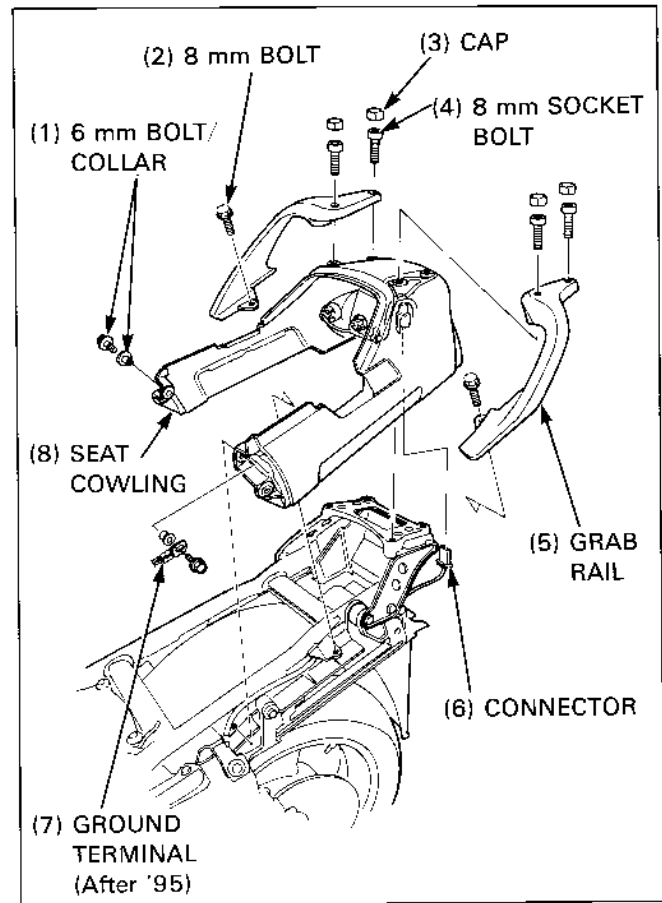

Saddlebag Stay

Remove the seat cowling.

Remove the four 8 mm bolts and the grab rail center plate. Remove the two 6 mm bolts, one 8 mm bolt and the saddlebag stay.

Torque:

Center plate 8 mm bolt: 35 N·m (3.5 kg-m, 25 ft-lb)

Saddlebag stay 6 mm bolt: 10 N·m (1.0 kg-m, 7 ft-lb)

8 mm bolt: 35 N·m (3.5 kg-m, 25 ft-lb)

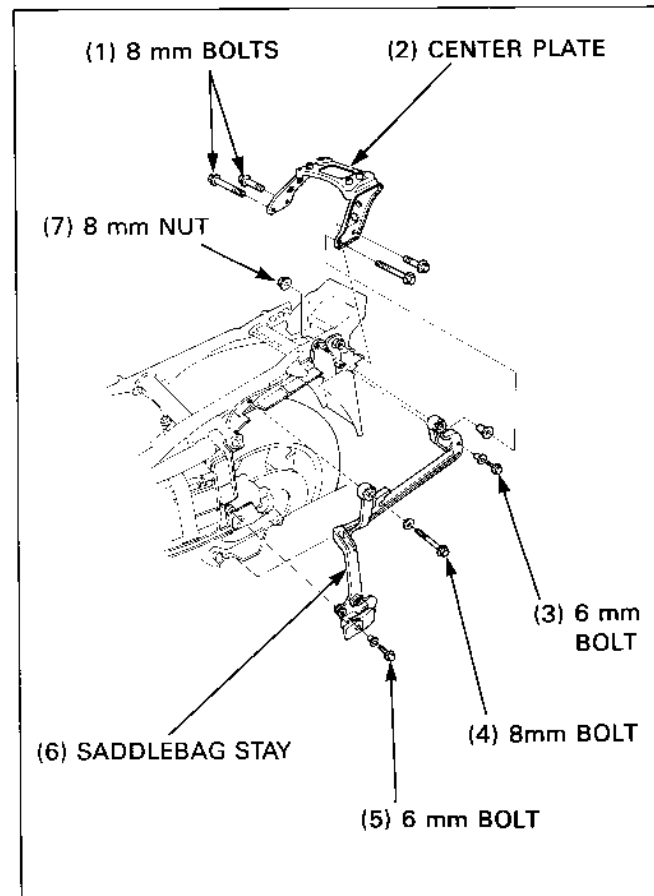

Rear Fender

Remove the battery (page 17-7).

Remove the left and right saddlebag stays (page 2-3).

Remove the four socket bolts, rear fender B and the saddlebag stay stopper.

Remove the starter motor cable from the starter relay switch, and remove the starter relay switch from the rear fender A.

Remove the three bolts and the battery holder.

Remove the fuse case (s).

Remove the two bolts and the center stand grip.

Remove the two mounting bolts and rear fender A.

Torque:

Center stand grip bolt: 10 N·m (1.0 kg-m, 7 ft-lb)

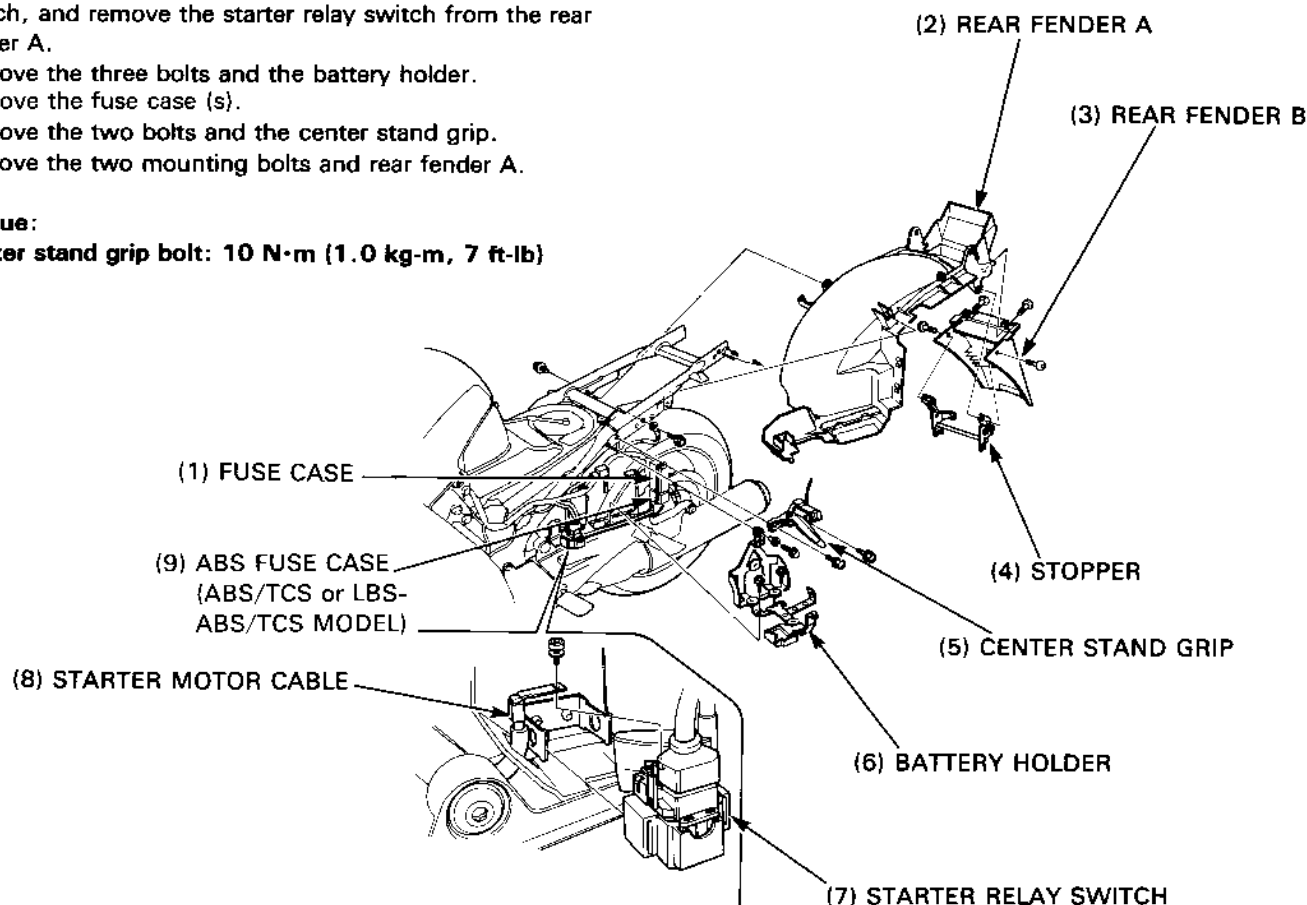

Lower Fairing

Remove the nine socket bolts and the lower fairing.

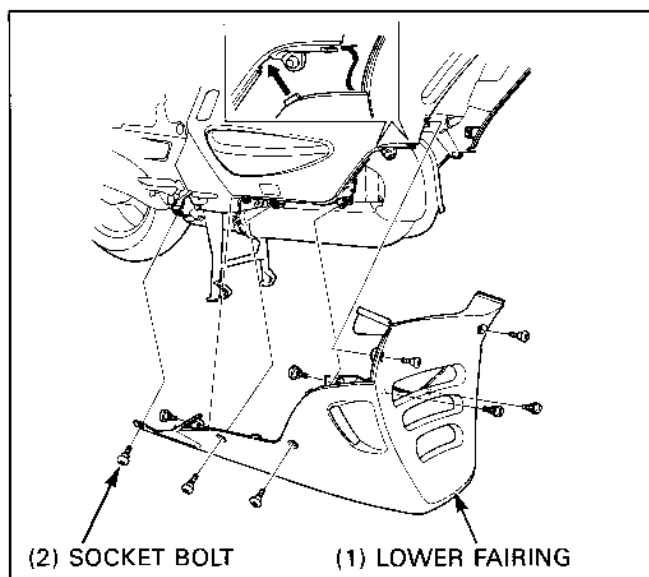

Pivot Cover

Remove the side cover (page 2-2).

Remove the three socket bolts and the pivot cover.

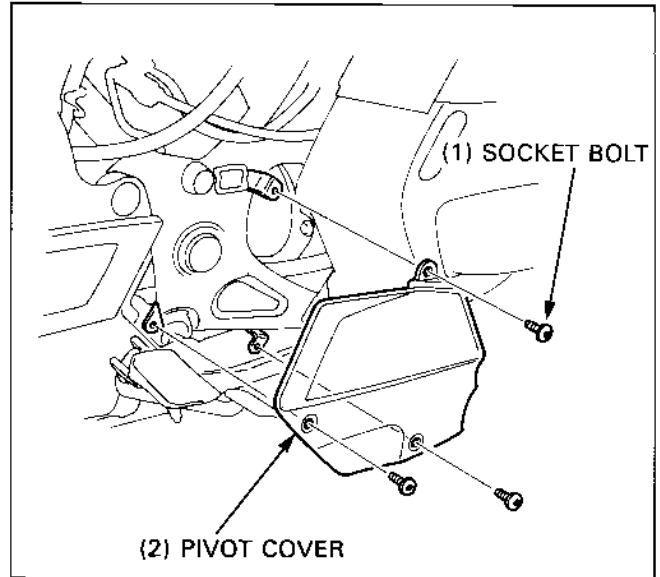

Maintenance Cover

Remove the two screws.

Release the four tabs by sliding the maintenance cover rearward and remove the cover.

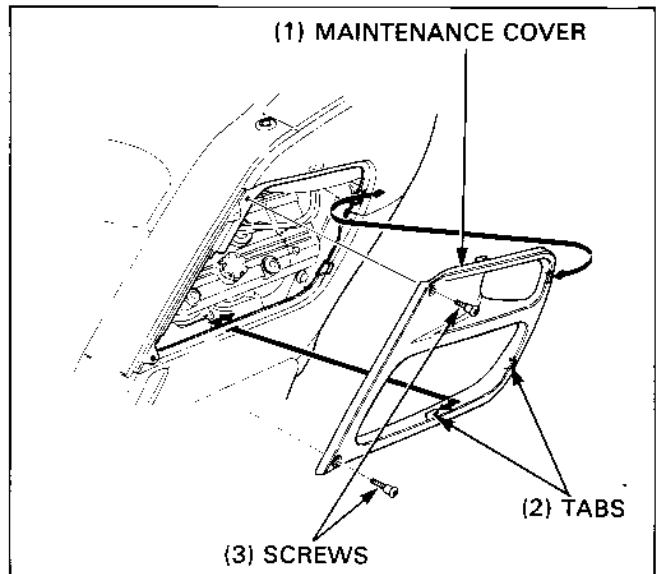

Top Shelter

Remove the left and right side covers (page 2-2).

Remove the two screws, two bolts and the top shelter.

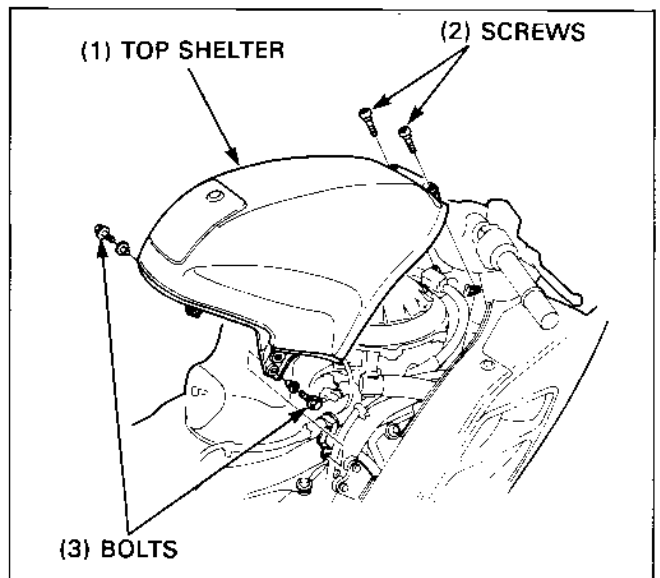

Fairing Pocket

Remove the maintenance cover (page 2-5).
Remove the top shelter (page 2-5).

Remove the six screws and the fairing pocket.

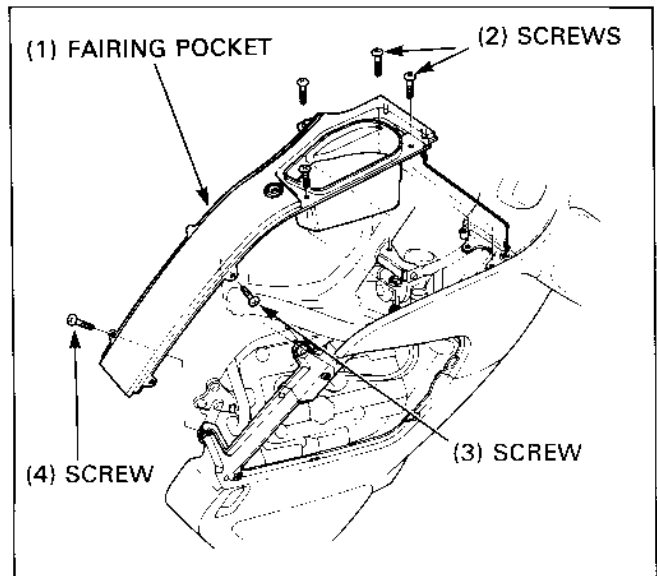

ABS/TCS or LBS-ABS/TCS model:

Remove the maintenance cover (page 2-5).
Remove the top shelter (page 2-5).

Remove the six screws.
Disconnect the two connectors and left fairing pocket.

NOTE

- The TCS OFF indicator turns on when the TCS switch connector is disconnected and then reconnected with the ignition switch ON. The TCS can be reactivated by pushing the TCS switch.

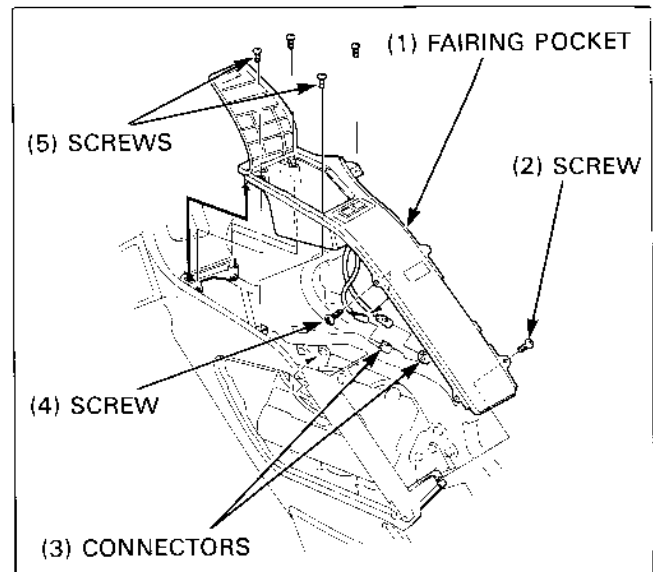

Windshield

Remove the five screws and the windshield.

Remove the two screws and trim clip attaching the windshield garnish.
Release the four tabs and remove the windshield garnish from the upper fairing.

Torque:

Windshield screw
0.6 N·m (0.06 kg-m, 0.43 ft-lb)

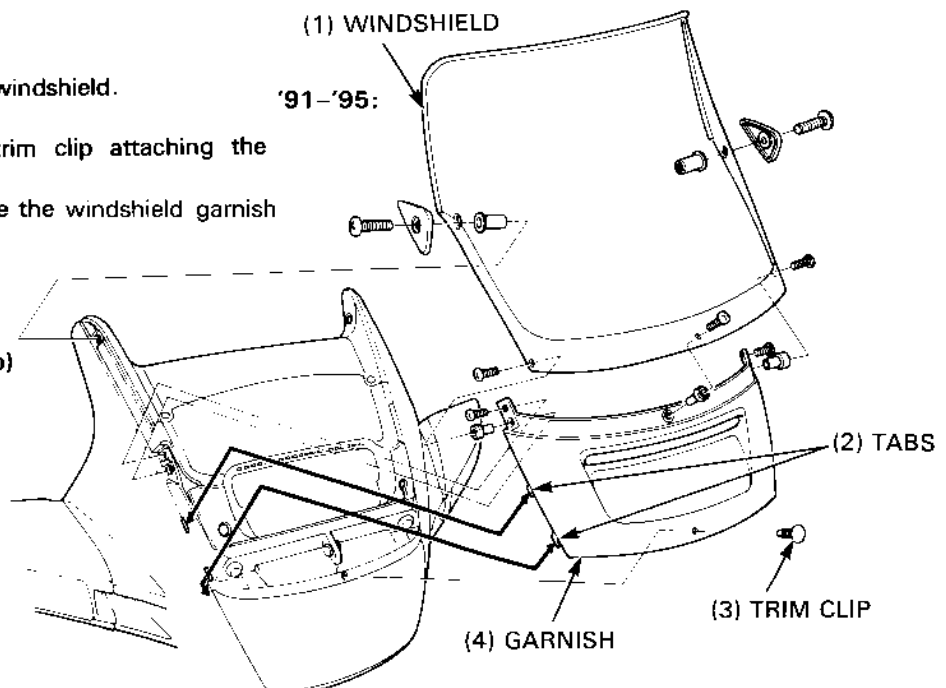

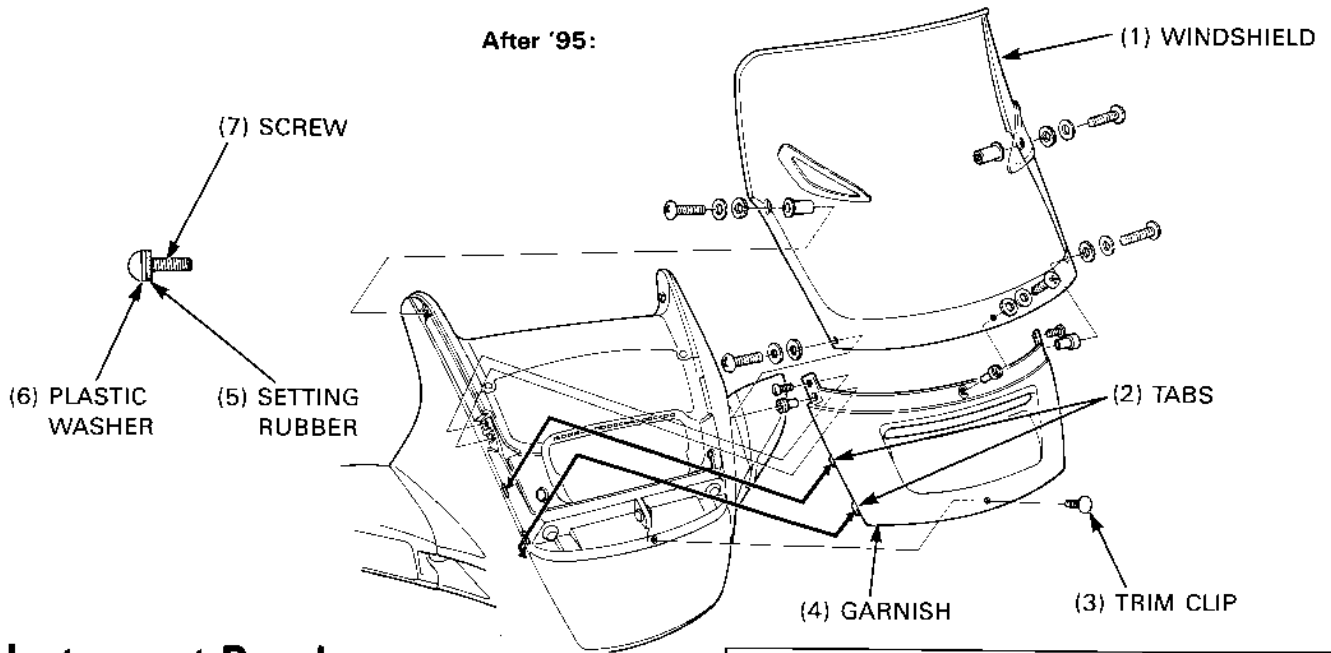

Instrument Panel

Remove the windshield and garnish (page 2-6).

Remove the four screws and the inner screen.

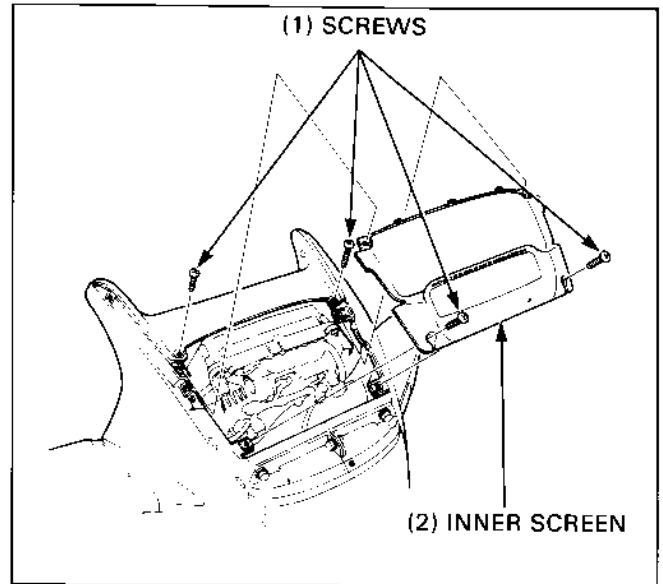

Remove the left and right fairing pockets (page 2-6).

Disconnect the clock connectors under the instruments.

NOTE

- Adjust the clock after installing the instrument panel.

Remove the set screw, set washer and the headlight adjuster knob.

Remove the headlight adjuster cable from the instrument panel by removing the plastic nut, rubber washer and washer.

Remove the two screws, release the four tabs and remove the instrument panel from the upper fairing.

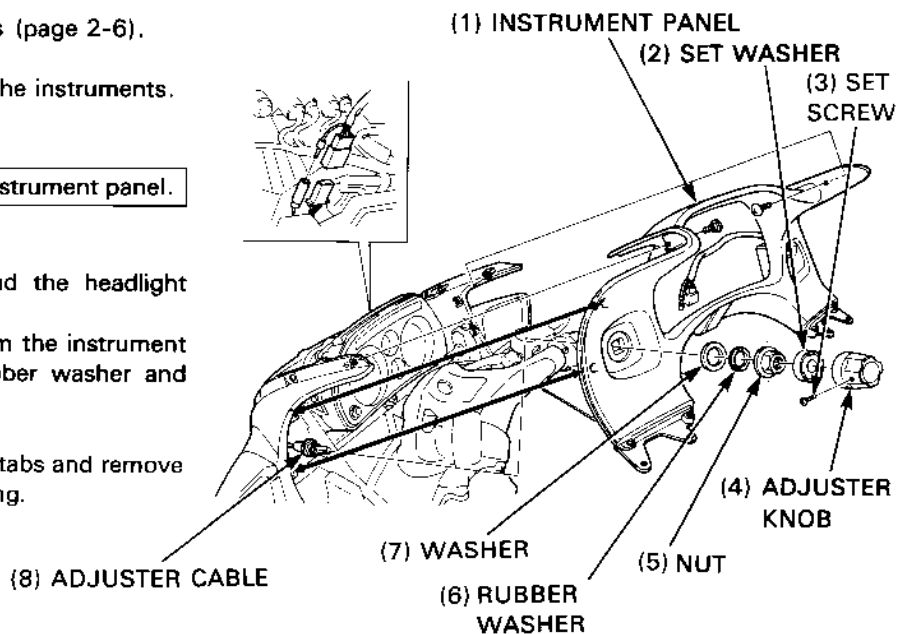

Middle Fairing Inner Cover

Disconnect the speedometer cable from the front wheel by removing the cable set screw.

Remove the two trim clips from the middle fairing by pulling them out.

Remove the six screws and the middle fairing inner cover.

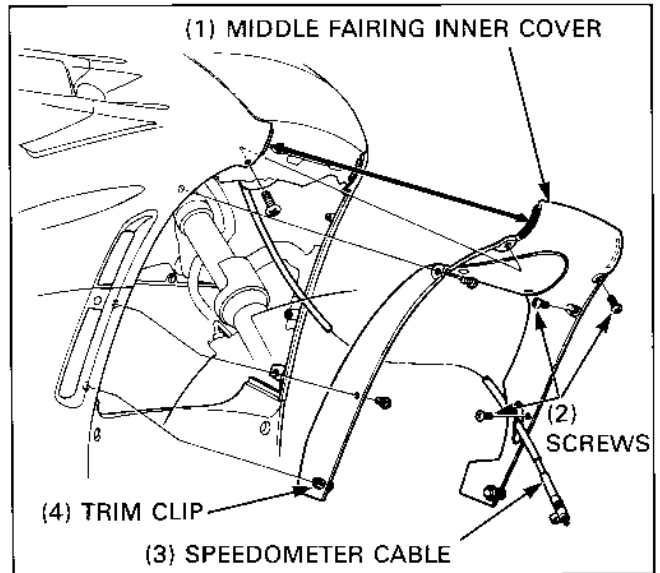

Middle Fairing

Remove the following:

- middle fairing inner cover (page 2-7)
- left and right fairing pockets (page 2-6)
- lower fairing (page 2-4).

Remove the socket bolt, three screws, trim clip, three bolts and the middle fairing.

NOTE

- At installation, align the boss of the middle fairing with the hole of the upper fairing properly.

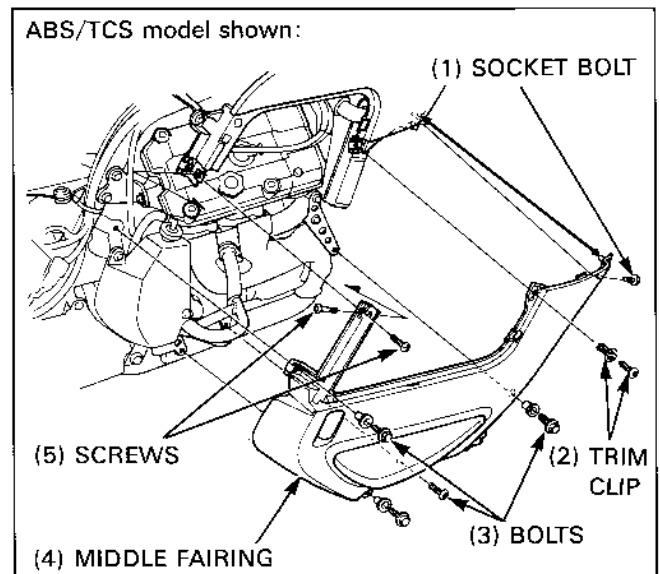

Rearview Mirror

Remove the rearview mirror case by carefully releasing the three bosses from the clips of the upper fairing. Disconnect the front turn signal connector.

Remove the trim clip and the mirror cover inside spacer.

Remove the two bolts and the rearview mirror.

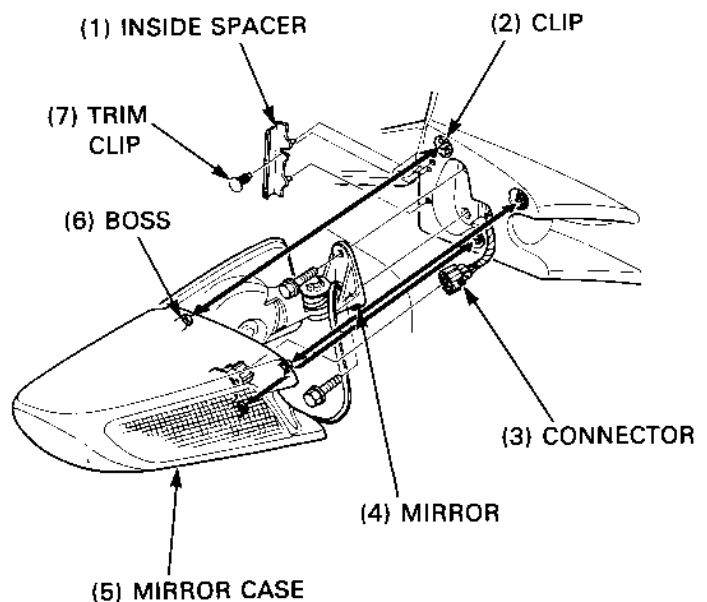

Upper Fairing

Removal/Installation

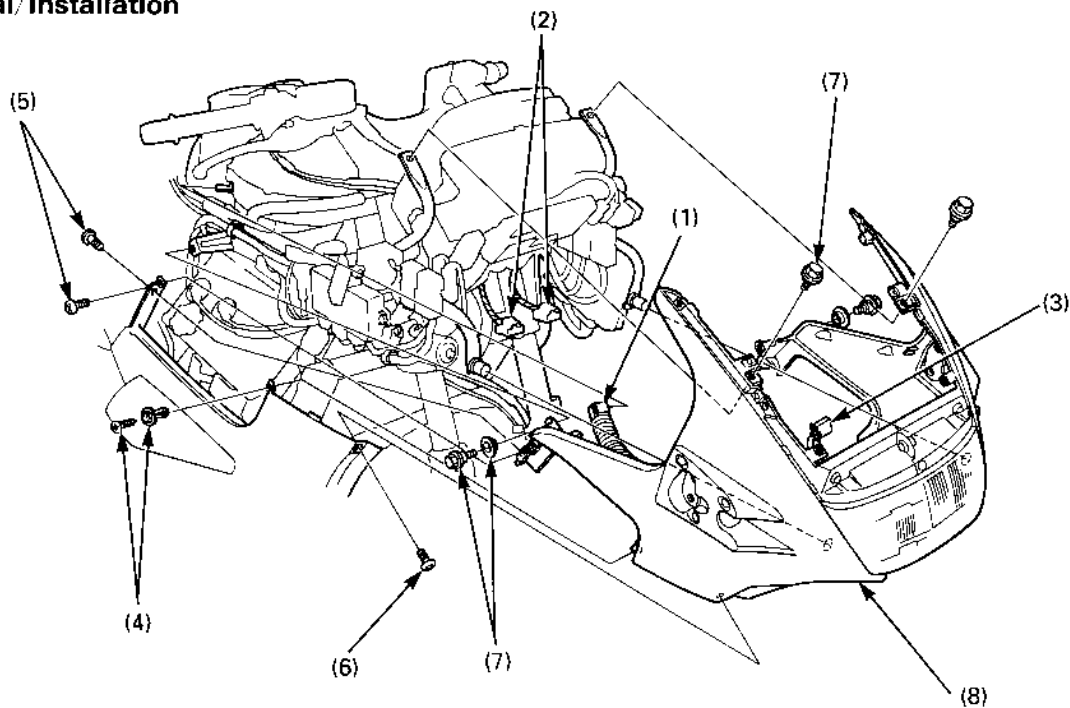

Requisite Service

- Left and right rear view mirrors (page 2-8).
- Instrument panel (page 2-7).
- Middle fairing inner cover (page 2-7).

Procedure	Q'ty	Remarks
Removal Order		Installation is in the reverse order of removal.
(1) Air duct	1	
(2) Headlight connector	2	
(3) Position light connector	1	
(4) Trim clip	2	
(5) Screw	4	
(6) Socket bolt	2	
(7) Bolt/collar	4/2	
(8) Upper fairing	1	At installation, align the holes in the headlight with the mounting bosses of the fairing stay.

Disassembly/Assembly

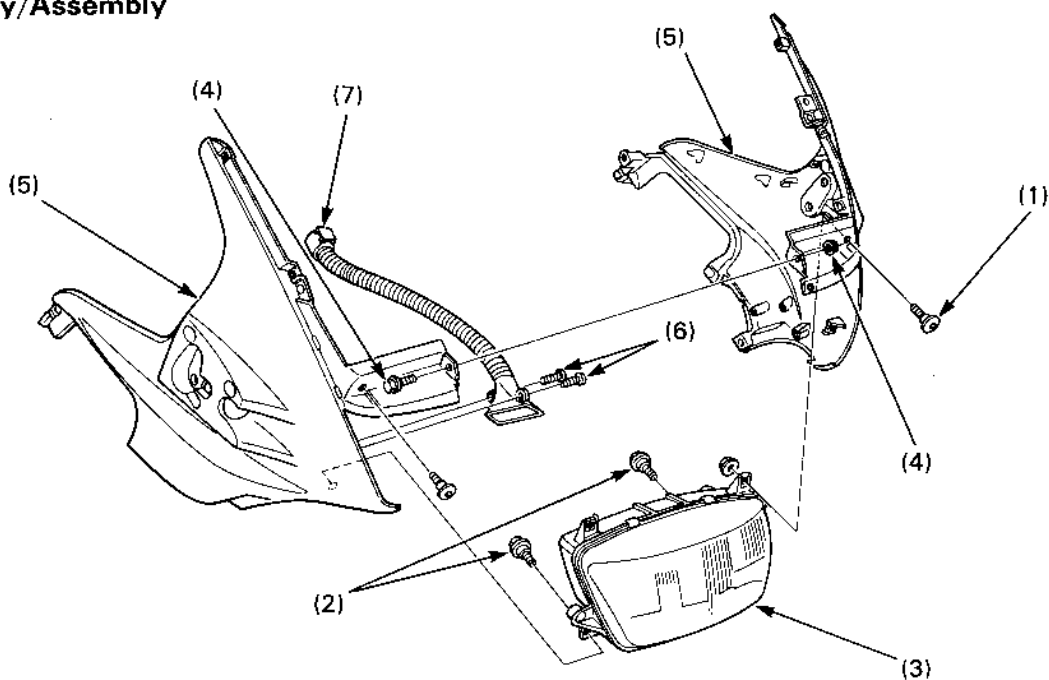

Requisite Service

- Upper fairing removal/installation (page 2-9).

Procedure		Q'ty	Remarks
Disassembly Order			Assembly is in the reverse order of disassembly.
(1)	Socket bolt/nut	2/2	
(2)	Bolt	2	
(3)	Headlight	1	
(4)	Bolt/nut	1/1	
(5)	Upper fairing	2	
(6)	Screw	2	
(7)	Air duct	1	

Front Fender (LBS-ABS/TCS model)

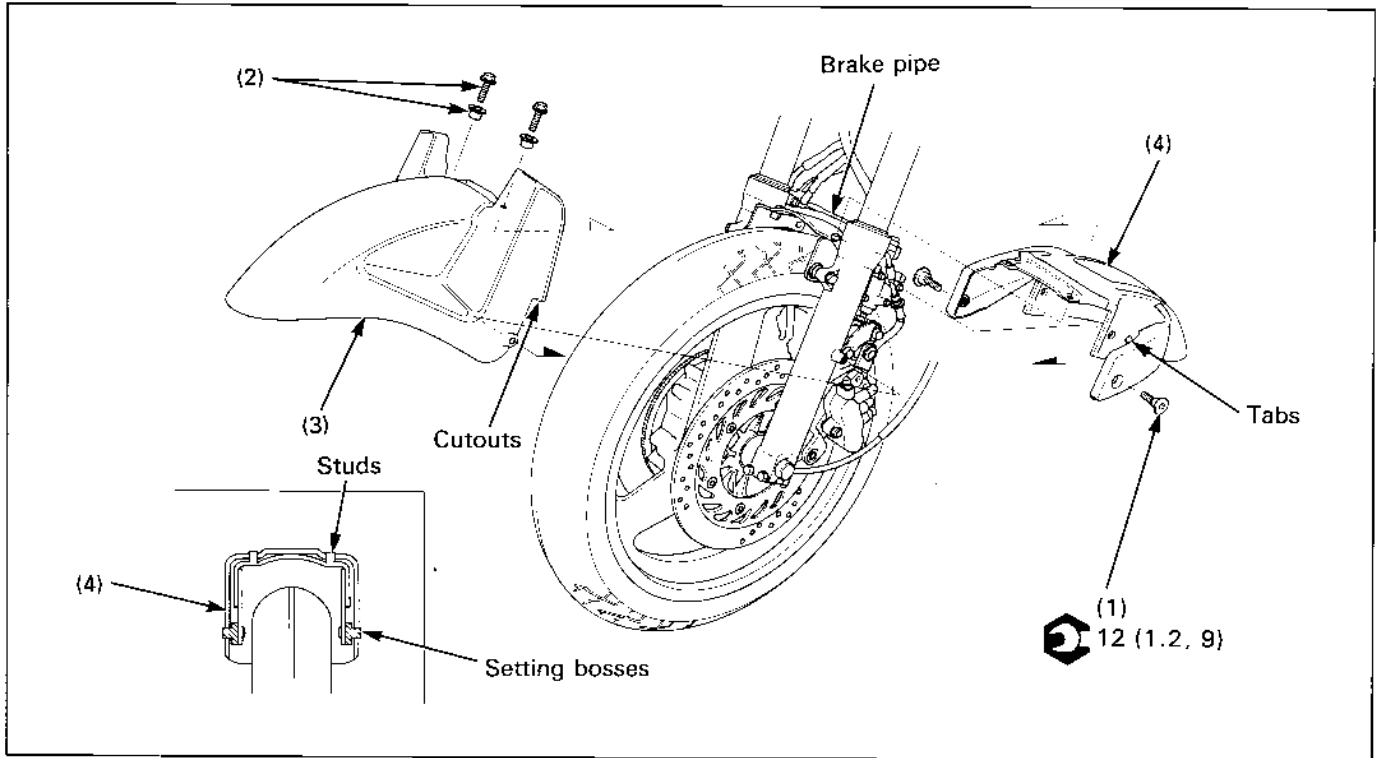

NOTE

• On the standard and ABS/TCS model, refer to page 13-6 "Front wheel removal/installation".

Procedure	Q'ty	Remarks
Removal Order		Installation is in the reverse order of removal.
(1) Socket bolt	2	
(2) Flange bolt/washer	2/2	
(3) Upper fender	1	When installing, align the cutouts with the tabs on the fender side covers.
(4) Lower fender	1	When installing, insert the fender end between the brake pipe and fender plate, and align the holes in the lower fender with the bolt hole studs and setting bosses on the fender plate.

Fuel Tank

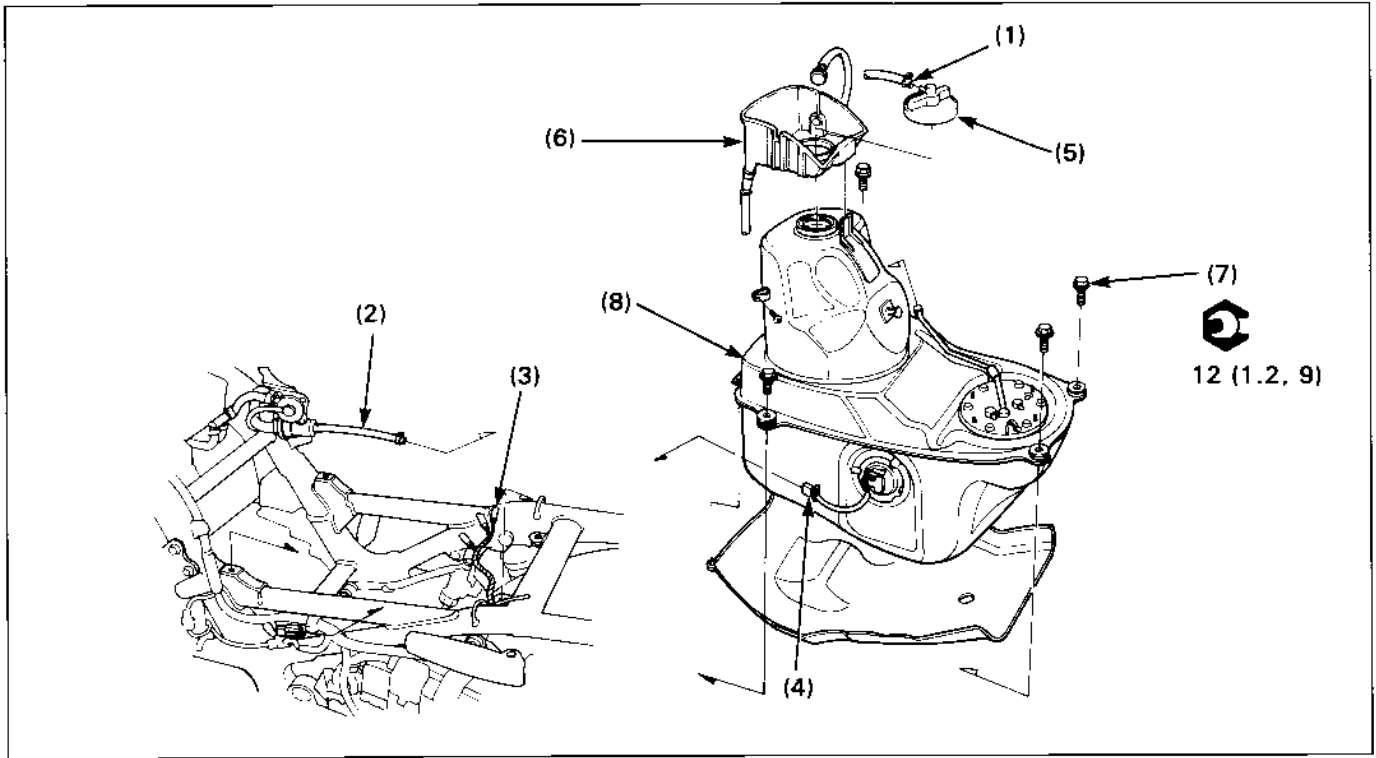

▲ WARNING

• Gasoline is extremely flammable and is explosive under certain conditions.

Requisite Service

- Air cleaner housing removal/installation (page 5-10)

Procedure	Q'ty	Remarks
Removal Order		Installation is in the reverse order of removal.
(1) Fuel tank breather tube	1	Remove from the fuel fill cap and clamp.
(2) Fuel line	1	
(3) Fuel pump connector	3	
(4) Fuel level sensor connector	1	
(5) Fuel fill cap	1	
(6) Fuel tank tray	1	
(7) Fuel tank mounting bolt	4	
(8) Fuel tank	1	
(9) Fuel tank heat protector	1	

Muffler

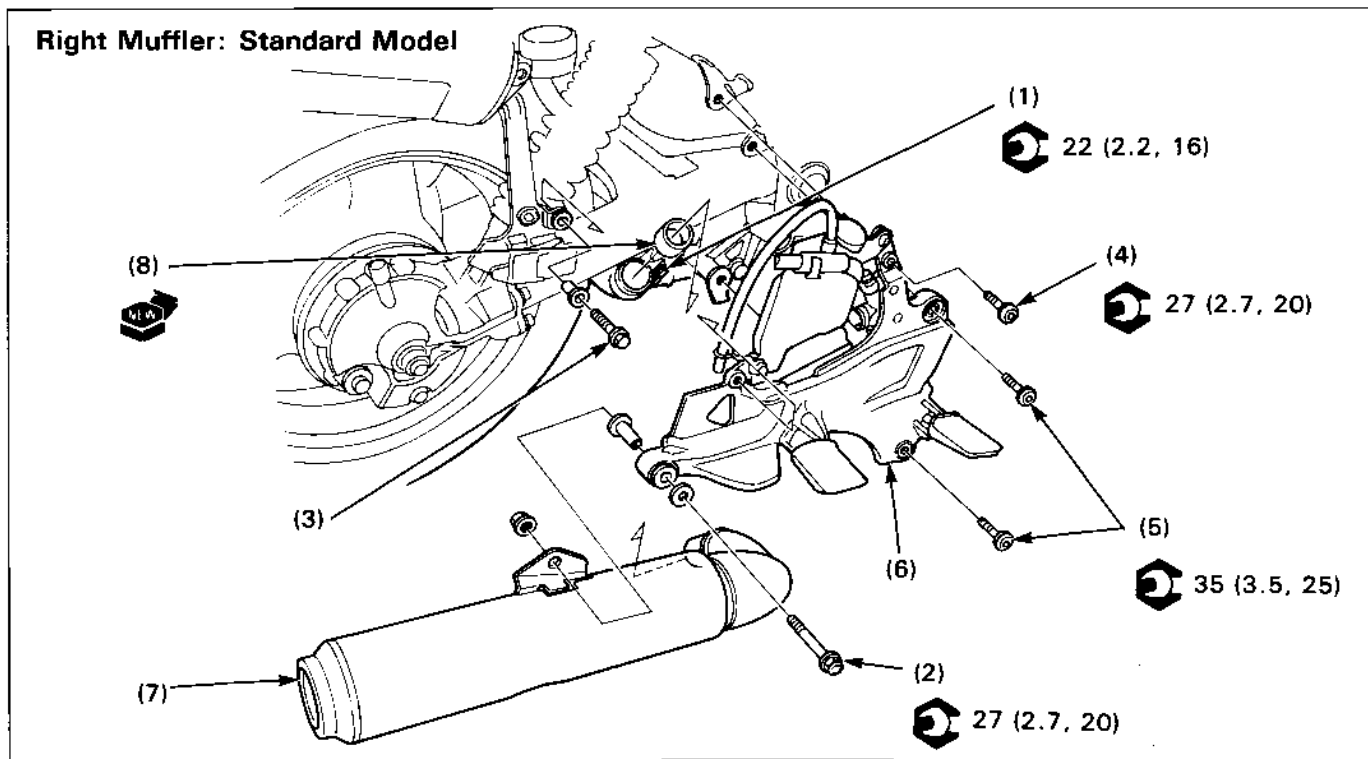

⚠ WARNING

- Do not service the exhaust system while it is hot.

Requisite Service

- Right pivot cover removal/installation (page 2-5)

Procedure	Q'ty	Remarks
Removal Order		Installation is in the reverse order of removal. Loosen the band bolts.
(1) Muffler band	2	
(2) Muffler mounting bolt	1	
(3) Right footpeg holder bolt 6 mm	1	
(4) 8 mm	1	
(5) 10 mm	2	
(6) Right footpeg holder	1	<ul style="list-style-type: none"> • Remove with the master cylinder and rear brake light switch installed. • Support with a piece of string.
(7) Right muffler	1	
(8) Gasket	1	

Right Muffler: ABS/TCS Model

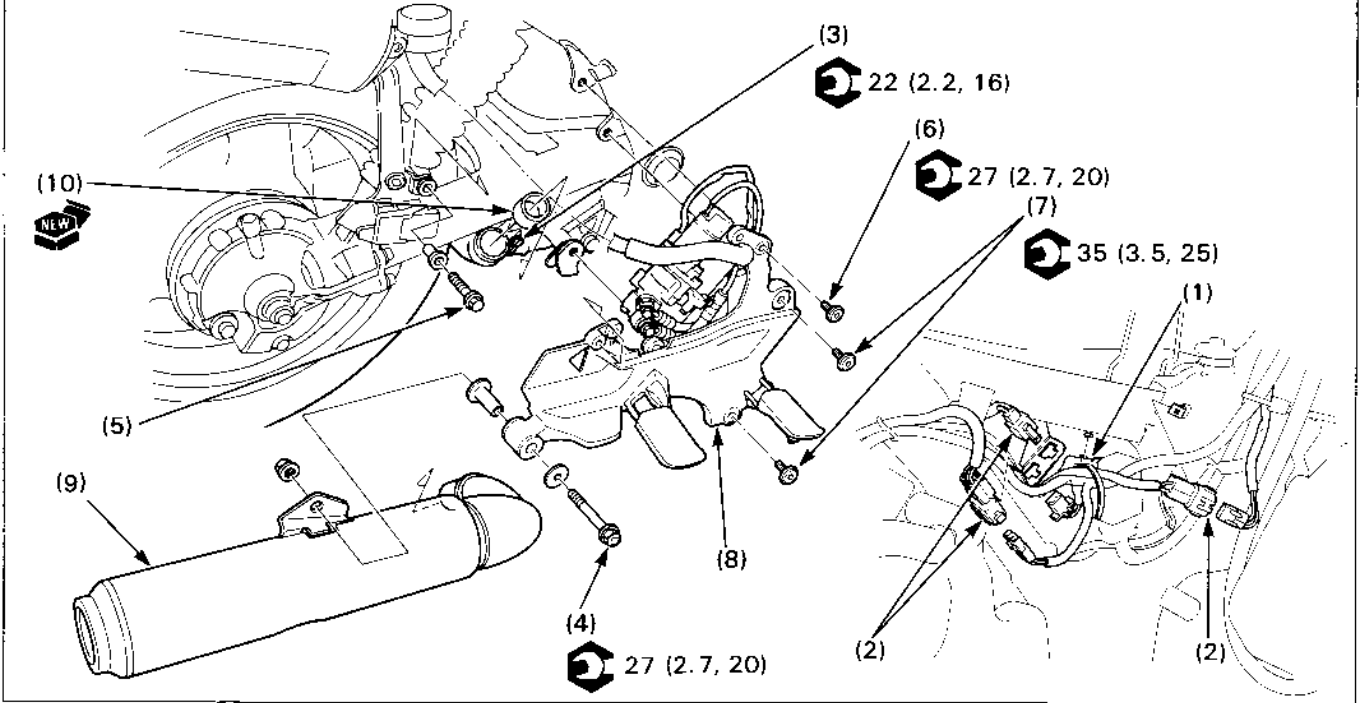

WARNING

- Do not service the exhaust system while it is hot.

Requisite Service

- Right pivot cover removal/installation (page 2-5)

Procedure	Q'ty	Remarks
Removal Order		Installation is in the reverse order of removal.
(1) Harness band	1	Loosen the band.
(2) Connector	3	
(3) Muffler band	2	Loosen the band bolts.
(4) Muffler mounting bolt	1	
(5) Right footpeg holder bolt 6 mm	1	
(6) 8 mm	1	
(7) 10 mm	2	
(8) Right footpeg holder	1	<ul style="list-style-type: none"> • Remove with the master cylinder and rear brake light switch installed. • Support with a piece of string.
(9) Right muffler	1	
(10) Gasket	1	

Right Muffler: LBS-ABS/TCS Model

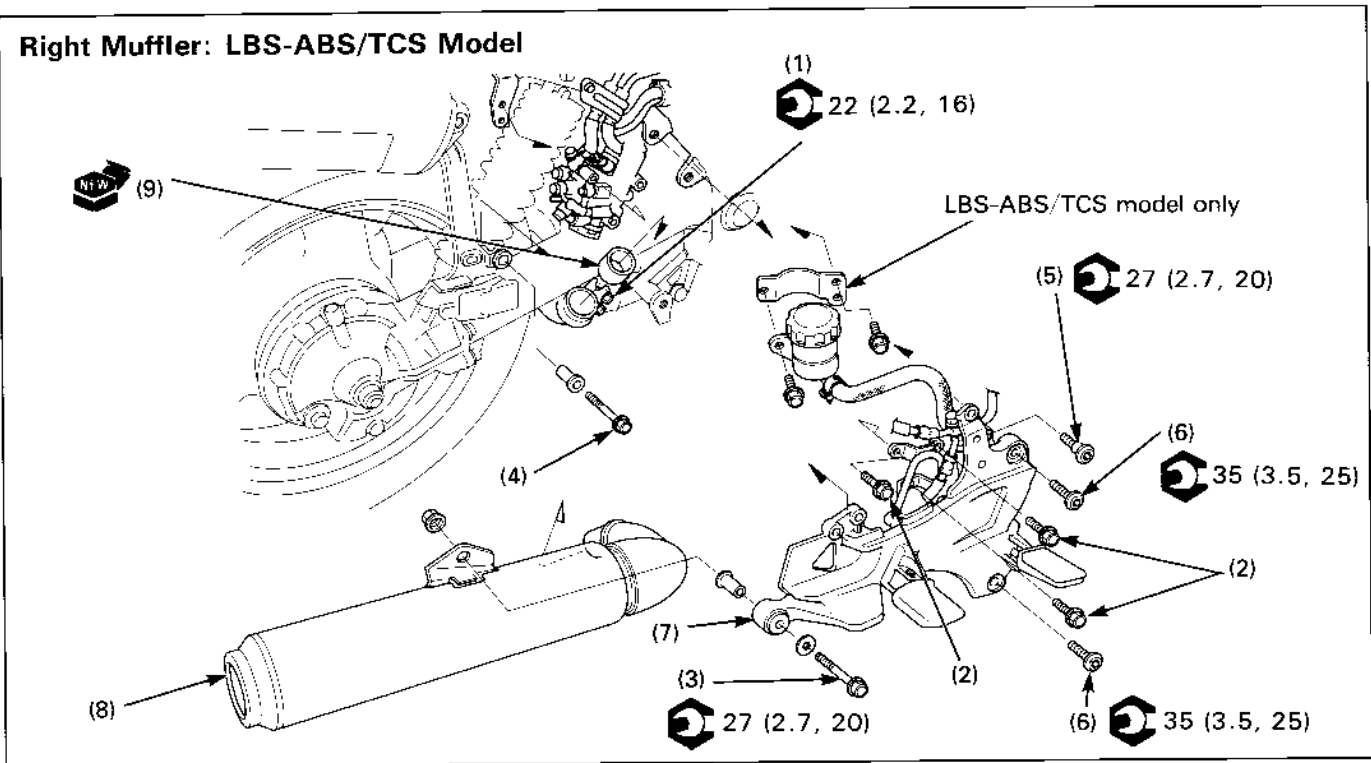

WARNING

- Do not service exhaust system while it is hot.

Requisite Service

- Right pivot cover removal/installation (page 2-5).

Procedure	Q'ty	Remarks
Removal Order		Installation is in the reverse order of removal.
(1) Muffler band	2	Loosen the band bolts.
(2) Modulator mounting bolt	3	
(3) Muffler mounting bolt	1	
(4) Right step holder bolt 6 mm	1	
(5) 8 mm	1	
(6) 10 mm	2	
(7) Right step holder	1	<ul style="list-style-type: none"> • Remove with the master cylinder and rear brake light switch installed. • Support with a piece of string.
(8) Right muffler	1	
(9) Gasket	1	

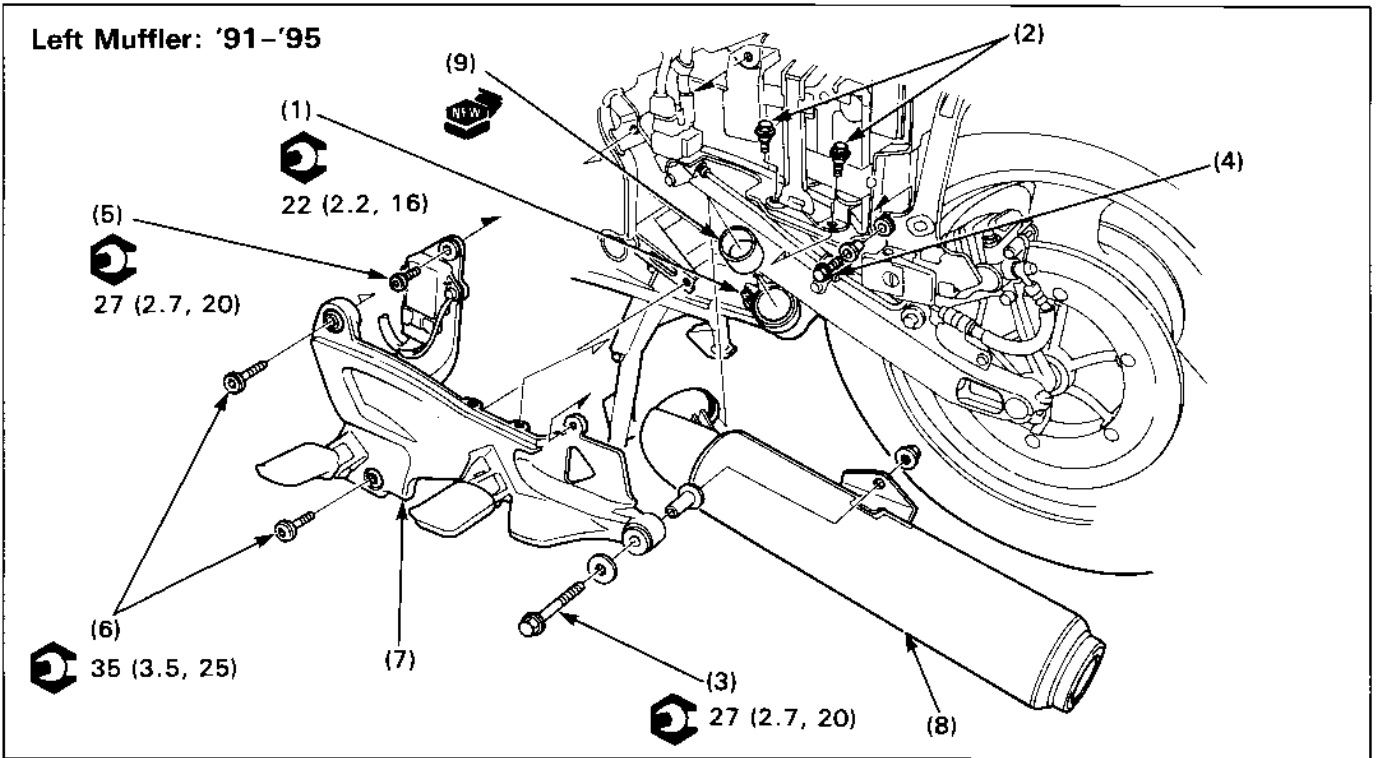

Requisite Service

- Left pivot cover removal/installation (page 2-5)
- Battery removal/installation (page 17-12)

Procedure	Q'ty	Remarks
Removal Order		Installation is in the reverse order of removal.
(1) Muffler band	2	Loosen the band bolts.
(2) Battery holder bolt	2	
(3) Muffler mounting bolt	1	
(4) Left footpeg holder bolt 6 mm	1	
(5) 8 mm	1	
(6) 10 mm	2	
(7) Left footpeg holder	1	Support with a piece of string.
(8) Left muffler	1	
(9) Gasket	1	

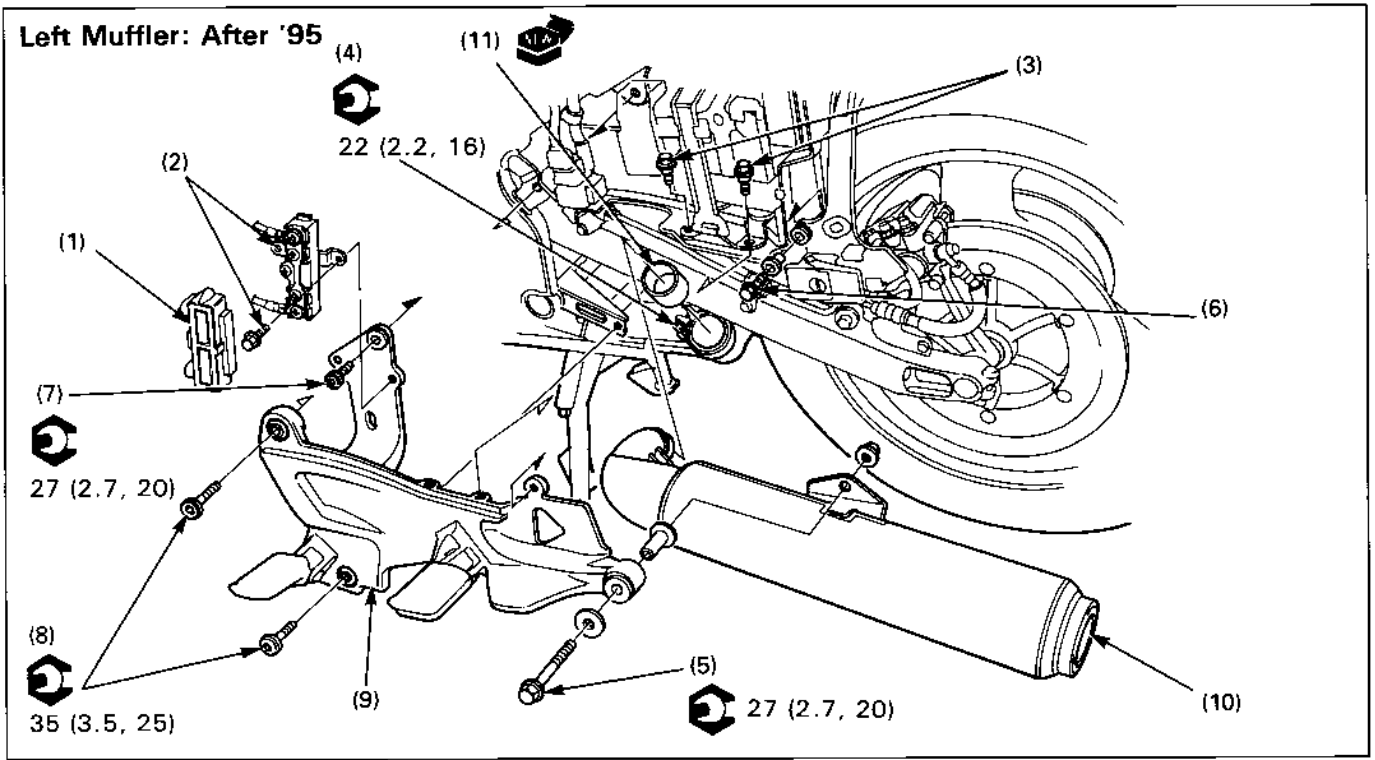

Requisite Service

- Left pivot cover removal/installation (page 2-5).
- Battery removal/installation (page 17-12).

Procedure	Q'ty	Remarks
Removal Order		Installation is in the reverse order of removal.
(1) Alternator fuse cover	1	
(2) Bolt/fuse base plate	2/1	
(3) Battery holder bolt	2	
(4) Muffler band	2	Loosen the band bolts.
(5) Muffler mounting bolt	1	
(6) Left step holder bolt 6 mm	1	
(7) 8 mm	1	
(8) 10 mm	2	
(9) Left step holder	1	
(10) Left muffler	1	
(11) Gasket	1	

Exhaust Pipe

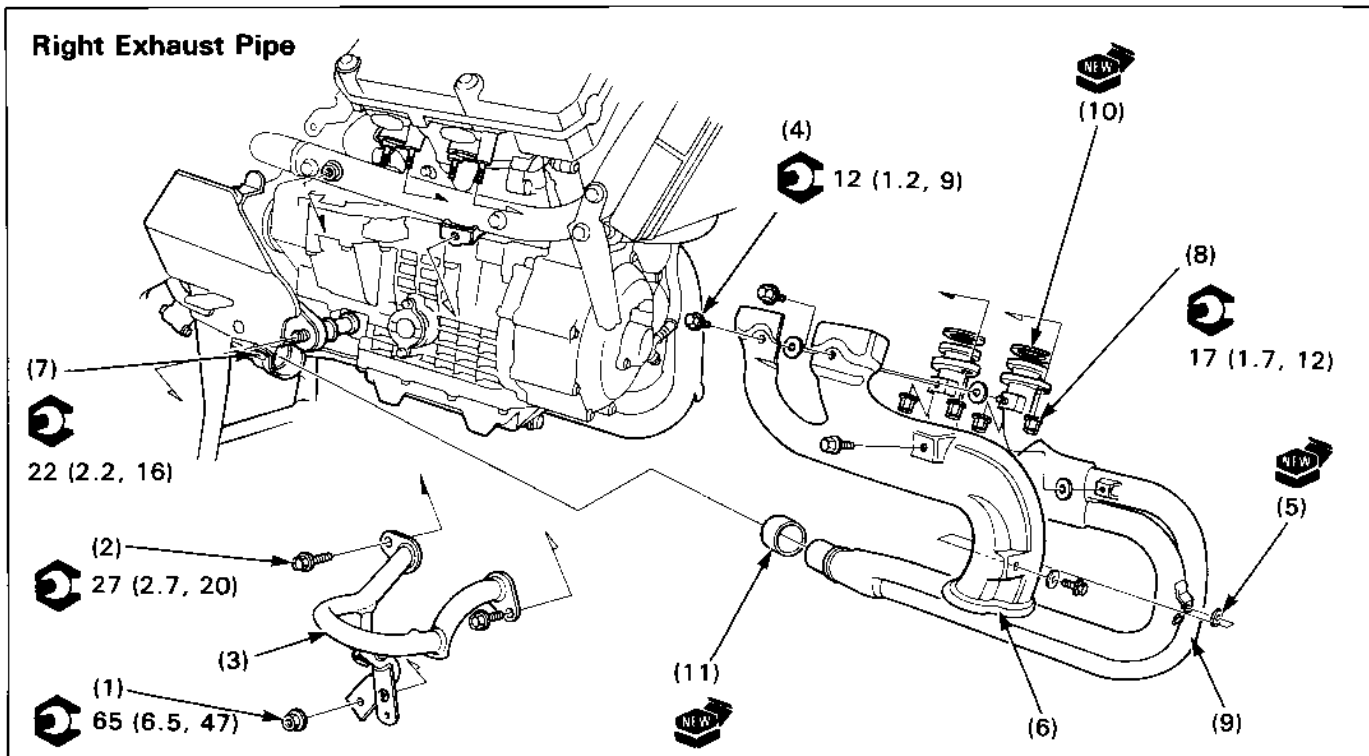

WARNING

• Do not service the exhaust system while it is hot.

Requisite Service

- Right middle fairing removal/installation (page 2-8)
- ABS/TCS or LBS-ABS/TCS Model:
Radiator reserve tank removal/installation (page 6-9)

Procedure	Q'ty	Remarks
Removal Order		Installation is in the reverse order of removal.
(1) Lower engine mounting nut	1	
(2) Bolt	2	
(3) Right engine guard	1	
(4) Bolt	4	
(5) Protector gasket	5	
(6) Right exhaust pipe protector	1	
(7) Exhaust pipe band	1	Loosen the band bolt.
(8) Exhaust pipe joint nut	4	
(9) Right exhaust pipe	1	
(10) Exhaust pipe gasket	2	
(11) Exhaust chamber gasket	1	

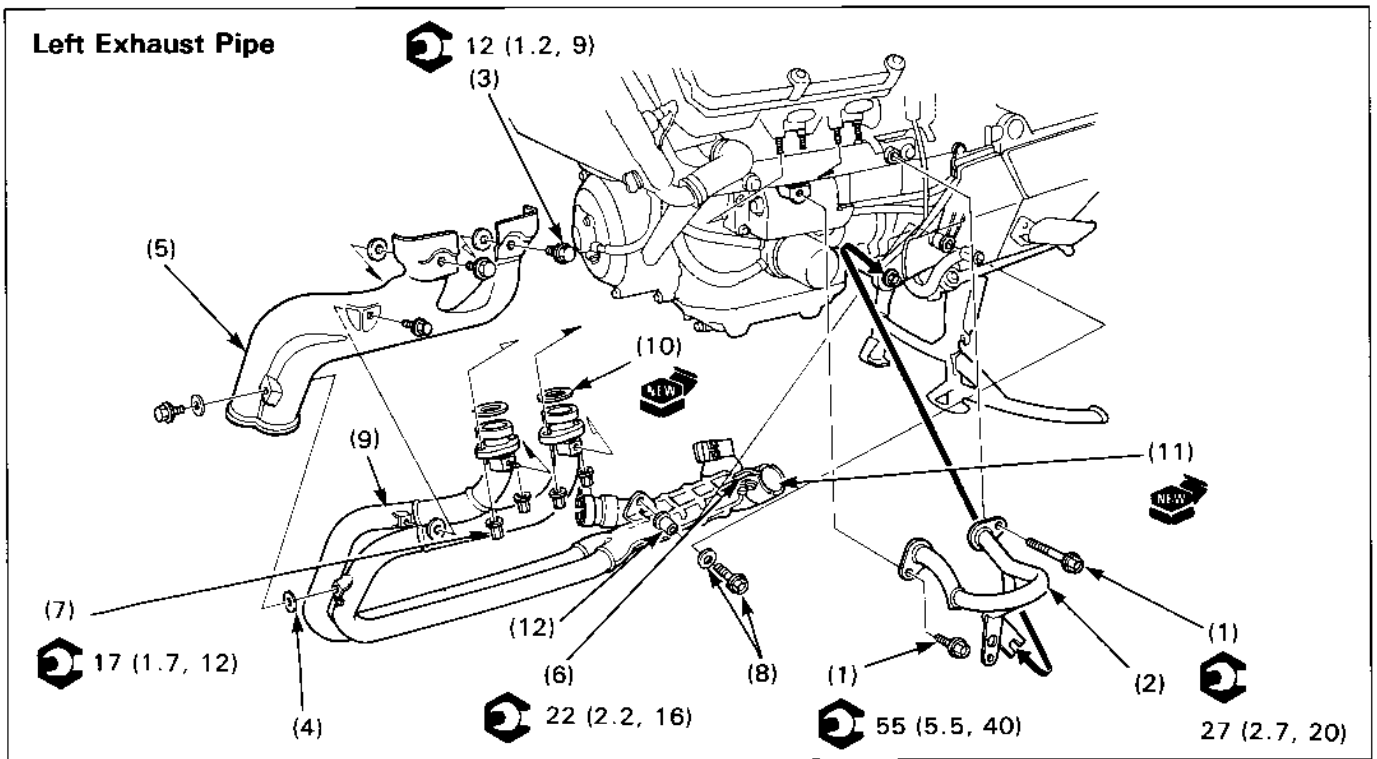

Requisite Service

- Left middle fairing removal/installation (page 2-8)
- Right exhaust muffler removal/installation (page 2-14)

Procedure	Q'ty	Remarks
Removal Order		Installation is in the reverse order of removal.
(1) Bolt	2	Loosen the band bolts. Installation (page 2-20)
(2) Left engine guard	1	
(3) Bolt	4	
(4) Protector gasket	5	
(5) Left exhaust pipe protector	1	
(6) Muffler band	4	
(7) Exhaust pipe joint nut	4	
(8) 8 mm mounting bolt/washer	1/1	
(9) Left exhaust pipe/chamber	1	
(10) Exhaust pipe gasket	2	
(11) Muffler gasket	2	
(12) Mounting collar	1	

Exhaust Pipe Installation

1. Make sure that the mounting collar is installed in position. Loosely install the left exhaust pipe/chamber to the frame with the 8 mm mounting bolt and washer.
2. Make sure that the exhaust pipe gaskets are installed in position, insert the left exhaust pipe flanges into the cylinder head and loosely install the joint nuts.
3. Insert the right exhaust pipe into the left exhaust pipe/chamber.
4. Make sure that the exhaust pipe gaskets are installed in position. Insert the right exhaust pipe flanges into the cylinder head and loosely install the joint nuts.
5. Tighten each pair of the joint nuts in 3 steps as follows:
 - A. Temporarily tighten either nut to 10 N·m (1.0 kg-m, 9 ft-lb).
 - B. Tighten the other nut to the specified torque.

Torque: 17 N·m (1.7 kg-m, 12 ft-lb)

- C. Tighten the nut temporarily tightened in step A to the specified torque.

6. Tighten the exhaust pipe band.





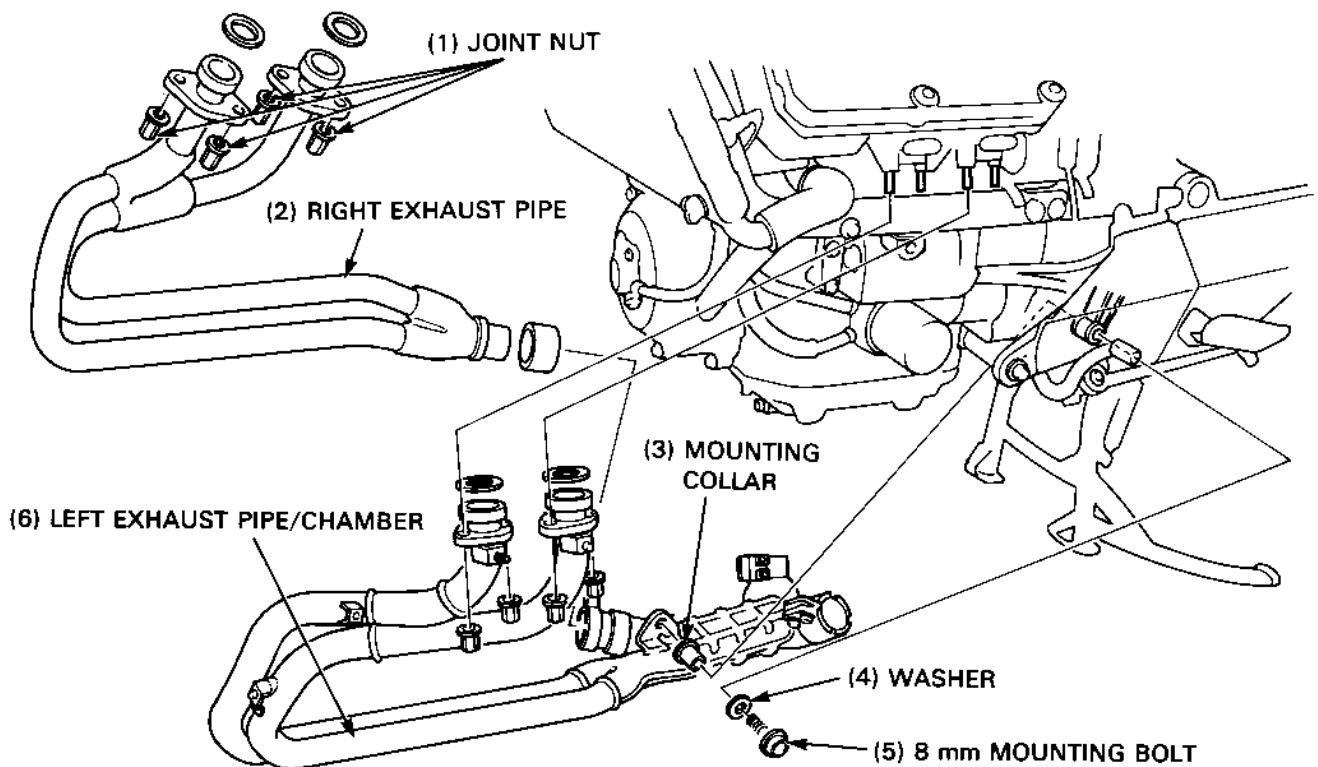









Torque: 22 N·m (2.2 kg-m, 16 ft-lb)

7. Tighten the 8 mm mounting bolt.



Symbols

The symbols used throughout this manual show specific service procedures. If supplementary information is required pertaining to these symbols, it would be explained specifically in the text without the use of the symbols.

	<p>Replace the part(s) with new one(s) before assembly.</p>
	<p>Use special tool</p>
	<p>Use optional tool. Use the same procedure you use to order parts.</p>
 <p>10 (1.0, 7.2)</p>	<p>Torque specification. 10 N·m (1.0 kg-m, 7.2 ft-lb)</p>
	<p>Use recommended engine oil, unless otherwise specified.</p>
	<p>Use molybdenum oil solution (mixture of the engine oil and molybdenum grease in a ratio of 1 : 1).</p>
	<p>Use multi-purpose grease (Lithium based multi-purpose grease NLGI #2 or equivalent)</p>
	<p>Use molybdenum disulfide grease (containing more than 3% molybdenum disulfide, NLGI #2 or equivalent) Example: Molykote® BR-2 plus manufactured by Dow Corning, U.S.A. Multi-purpose M-2 manufactured by Mitsubishi Oil Japan</p>
	<p>Use molybdenum disulfide paste (containing more than 40% molybdenum disulfide, NLGI #2 or equivalent) Example: Molykote® G-n Paste manufactured by Dow Corning, U.S.A. Honda Moly 60 (U.S.A. only) Rocol ASP manufactured by Rocol Limited, U.K. Rocol Paste manufactured by Sumico Lubricant, Japan</p>
	<p>Use silicone grease</p>
	<p>Apply a locking agent. Use a middle strength locking agent unless otherwise specified.</p>
	<p>Apply sealant</p>
	<p>Use brake fluid, DOT 3 or DOT 4. Use the recommended brake fluid, unless otherwise specified.</p>
	<p>Use Fork or Suspension Fluid.</p>